

PROJECT: Landscape Renovation/Enhancement US 74A, Isothermal College Entrance - Spindale, NC

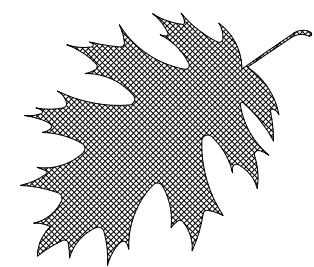

# PROPOSED HIGHWAY LANDSCAPE DEVELOPMENT PROJECT

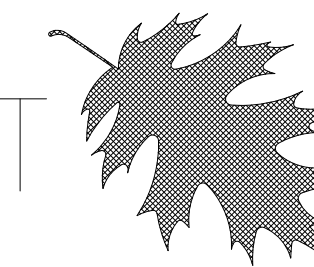

T.I.P. #	STATE PROJECT W.B.S. #	SHEET #	SHEET # TOTAL
	3713.3.32	L1	3
FED. PROJ. #	DESCRIPTION	DIVISION	
	Landscape Renovation/Enhancement US 74A, Isothermal College Entrance - Spindale, NC	13	

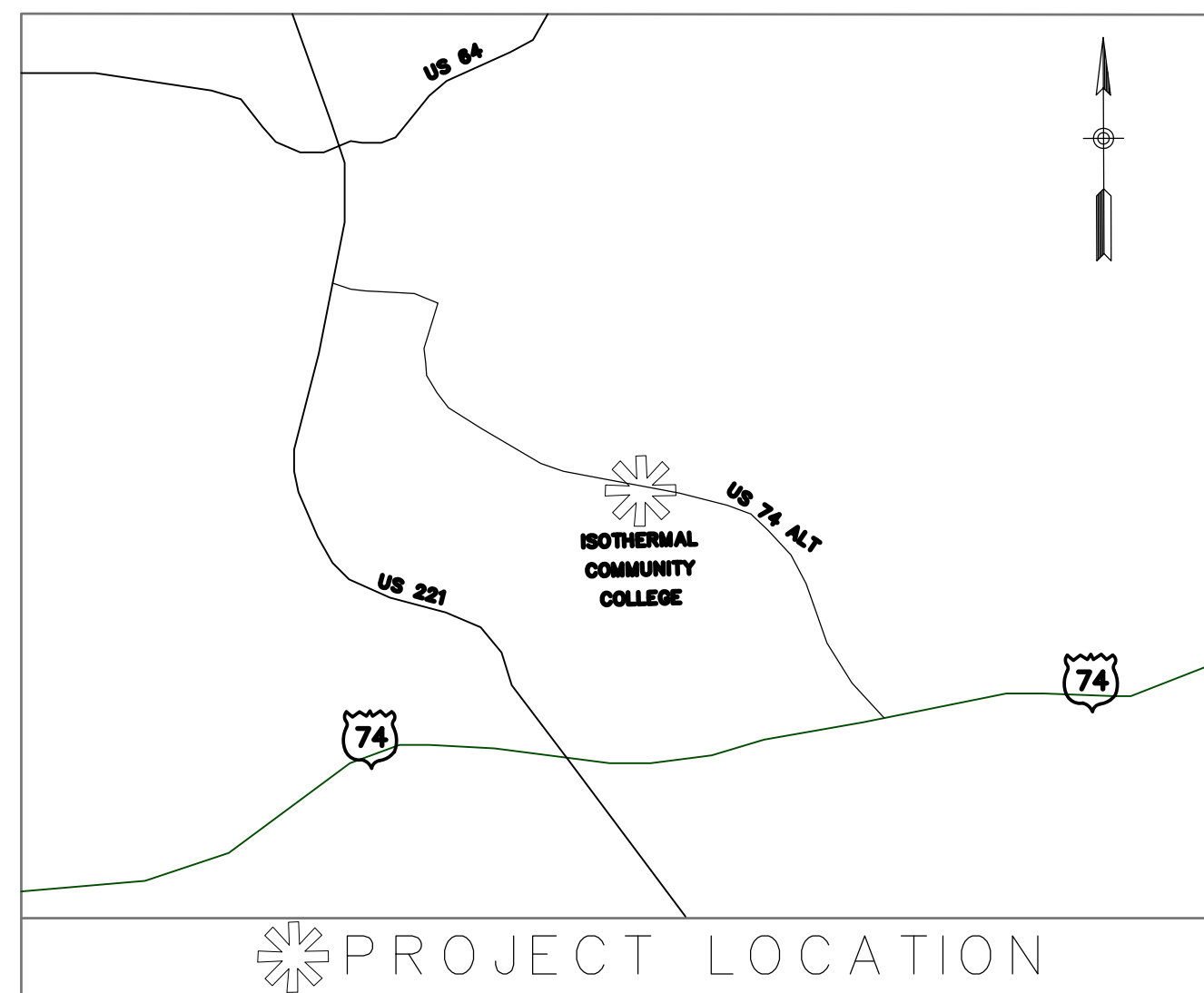
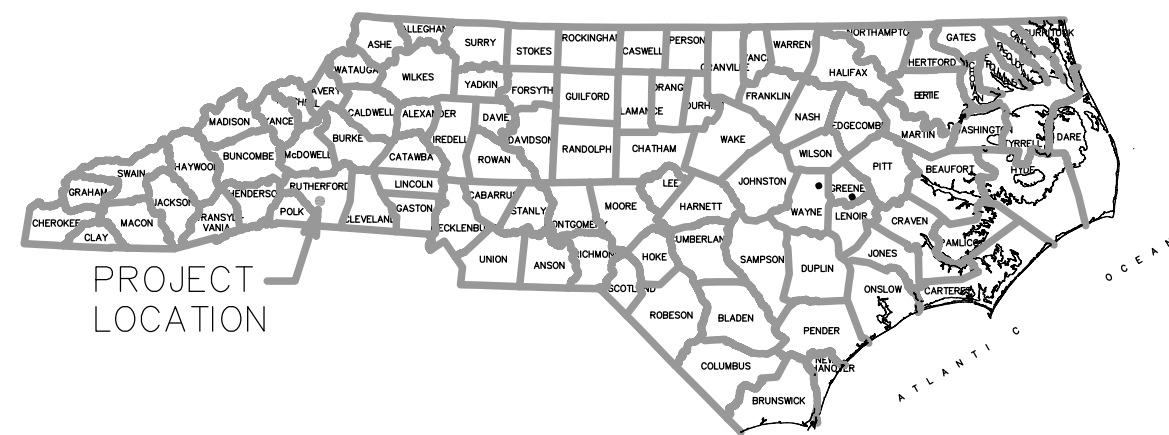

## SUMMARY OF QUANTITIES:

### PLANT MATERIALS

Qty	Unit	Key	Botanical Name	Common Name	Furnish	ASNS	Spacing
<b>Shrubs</b>							
115	ea	CH	Cephalotaxus harringtonia 'Prostrata'	Creeping Plum Yew	15-18", #3 Container	3.2.1	3' O.C.
<b>Groundcover</b>							
113	ea	HP	Heuchera 'Peppermint Spice'	Peppermint Spice Coral Bells	#1 Container, fully rooted	12.3	12" O.C.
4615	ea	SH	Sporobolus heterolepis 'Tara'	Dwarf Prairie Dropseed	4" Container, fully rooted	12.4	12" O.C.
3500	ea	NA	Narcissus 'Carlton'	Daffodil	RN III	10.19	4-5 inches O.C.

### OTHER ITEMS

Quantity	Unit	Description
680	SY	Post-Emergence Herbicide Treatment for Plant Beds (6120 sf)
680	SY	Pre-Emergence Herbicidal Treatment for Plant Beds (6120 sf)
86	CY	Mulch for Planting (4" thick) 6937 sf
7	M/G	Water for Planting
25	CY	Topsoil 1365 sf @ 6"
680	LF	New Aluminum Fence
0.7	Acre	Selective undergrowth removal and pruning (30,600 sf)
2	Each	Selective Tree Removal, 18"

### ESTABLISHMENT PERIOD

Quantity	Unit	Description
12	Cycle	Monthly Establishment and Warranty Work

### CONVENTIONAL SYMBOLS

County Line	-----
City or Town Line	-----
Exist. Right of Way Line Marker	-----▲-----
Prop. Right of Way Line Marker (By Others)	-----▲-----
Prop Right of Way Line Marker (By Contract)	-----▲-----
Exist. Control of Access Line	-----○-----
Prop. Control of Access Line	-----○-----
Property Line	-----E-----
Easement Line	-----E-----
Slope Stake Line	-----
Exist. Fence	-----+-----
Prop. Woven Wire Fence	-----+-----
Prop. Chain Link Fence	-----+-----
Exist. Road	=====
Prop. Road	=====
Guardrail	-----T-----
Survey Line	-----+-----
Denotes Line Equality	-----●-----
Bridge	=====
Culvert	=====
Railroad	=====
Woods	◆◆◆ OR .OR
Exist. Telephone Pole	-----●-----
Prop. Telephone Pole	-----○-----
Tower Pole and Line	-----●-----
Exist. Power Pole	-----●-----
Prop. Power Pole	-----○-----
Sanitary Sewer Line	-----SS-----
Water Line	-----+-----
Gas Line	-----+-----
Picnic Shelter	-----□-----
Regeneration	-----X-----
Reforestation	-----X-----

## INDEX OF SHEETS:

- L1 ... Title Sheet,
- Summary of Quantities
- L2 ... Planting and Fence Details
- L3 ... Planting Plan

## GENERAL NOTES:

- Verify locations of pertinent site improvements installed under other sections. If any part of this plan cannot be followed due to site conditions, contact Landscape Architect for instructions prior to commencing work.
- Exact locations of field staked plant materials to be approved by the Landscape Architect or Engineer in the field prior to installation.
- Verify plant counts and square footages: Quantities are provided as Owner information only. If quantities on plant list differ from graphic indications, then graphics shall prevail.
- Contact the local underground utility services for utility location and identification.
- Perform excavation in the vicinity of underground utilities with care and if necessary, by hand. The Contractor bears full responsibility for this work and disruption or damage to utilities shall be repaired immediately at no expense to the Owner.
- Align and equally space in all directions shrubs so designated per these notes and drawings.
- Square footages for Selective undergrowth removal areas are approximate.
- Tree to be removed will be tagged by engineer in the field.

## PREPARED BY:

Design Workshop  
60 Biltmore Ave. Suite 3C  
Asheville, NC 28801  
(828) 225-6901  
www.designworkshop.com

DATE:	REVISIONS
3-26-14	Preliminary Design Concept
4-13-15	Revisions based on NCDOT site review
4-13-15	Final Revisions

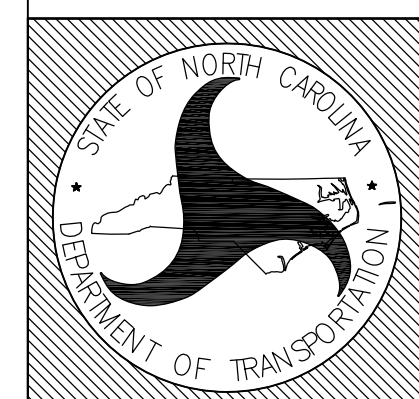

STATE OF  
NORTH CAROLINA  
DEPARTMENT OF TRANSPORTATION

LOCATION: US 74A Isothermal Community College, Spindale, NC  
TYPE of WORK: Landscape Development  
COUNTY: Rutherford County

Seal:

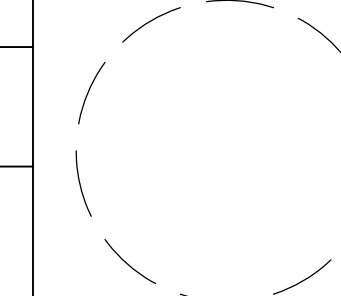

2004 American Standard for Nursery Stock  
2012 NCDOT STANDARD SPECIFICATIONS  
PREPARED IN THE OFFICE OF:  
NCDOT- ROADSIDE ENVIRONMENTAL UNIT  
LANDSCAPE DESIGN & DEVELOPMENT SECTION  
1557 MAIL SERVICE CENTER  
RALEIGH NC 27699 919-707-2935



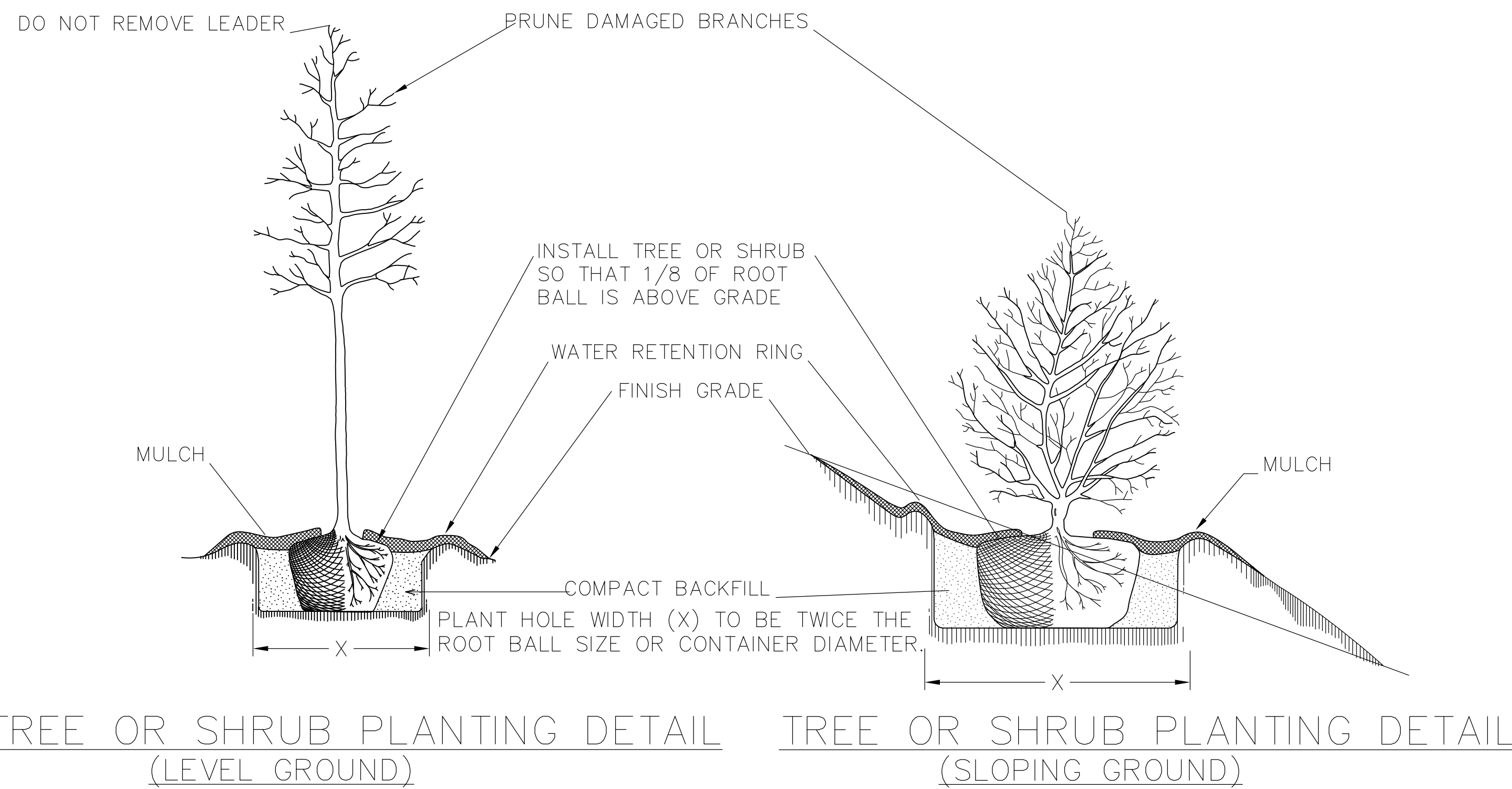

TREE OR SHRUB PLANTING DETAIL  
(LEVEL GROUND)

TREE OR SHRUB PLANTING DETAIL  
(SLOPING GROUND)

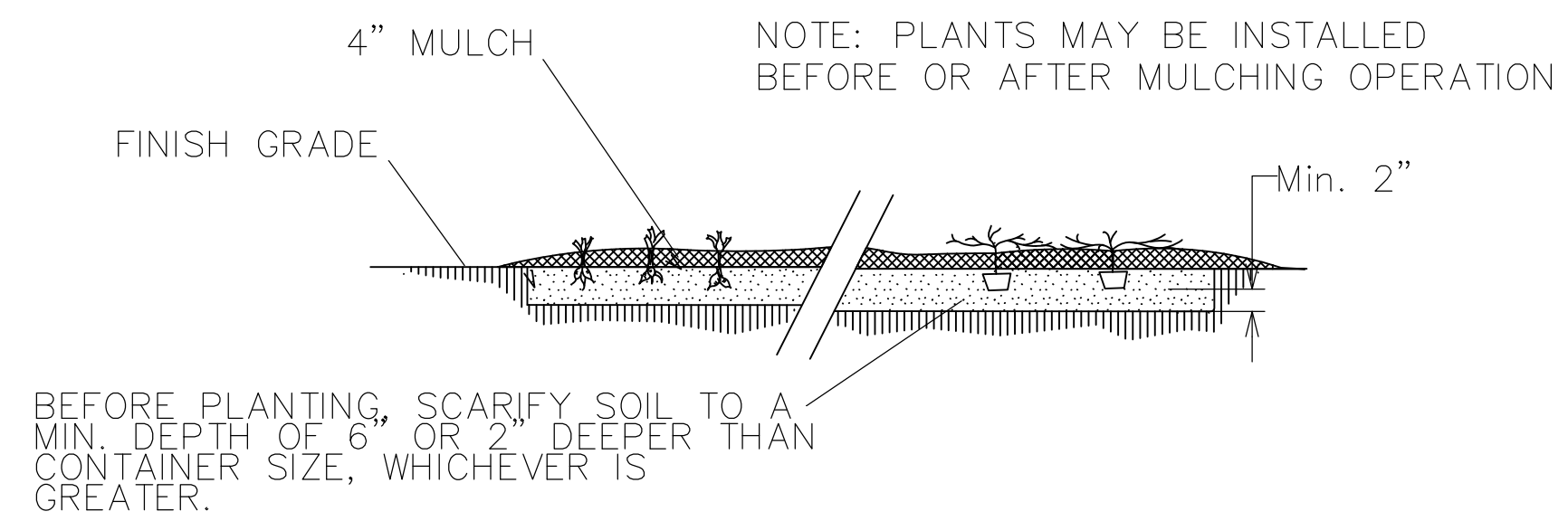

GROUND COVER/ BEDDING  
PLANT DETAIL

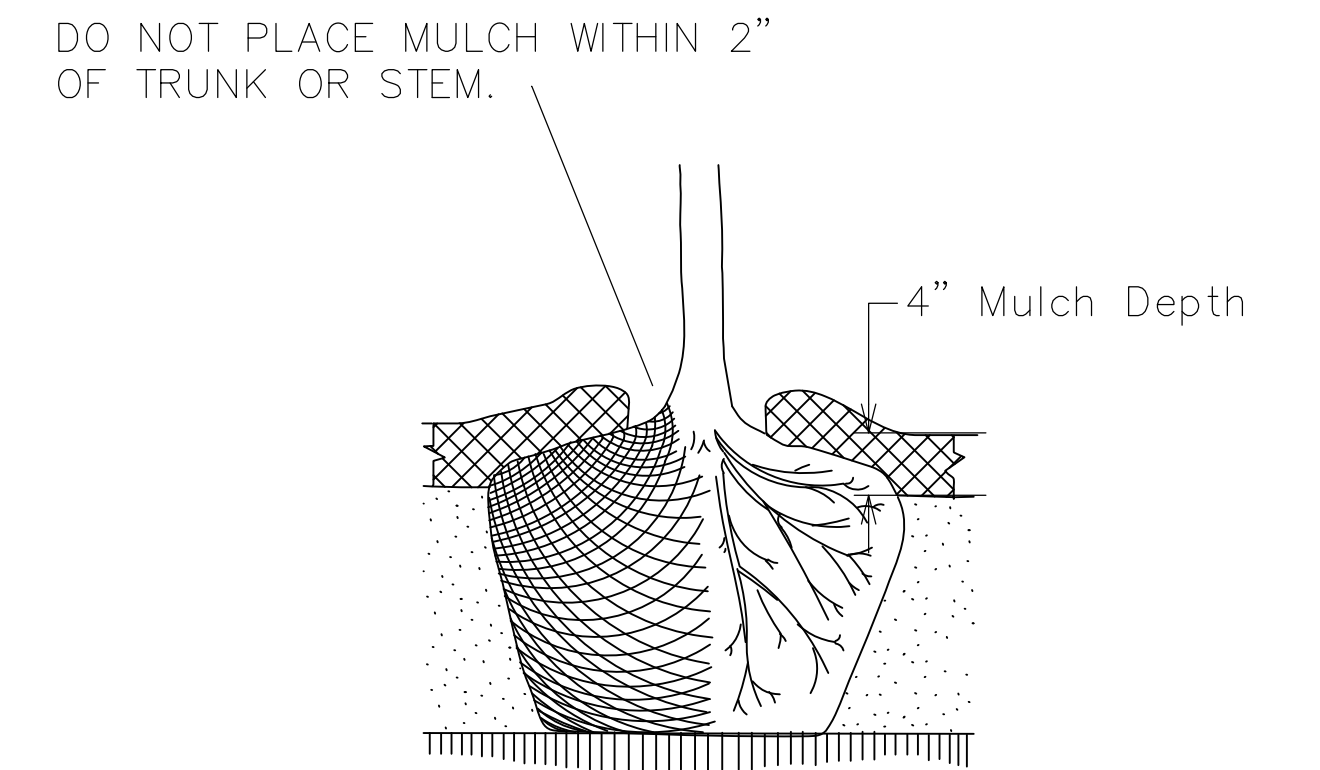

MULCH DETAIL

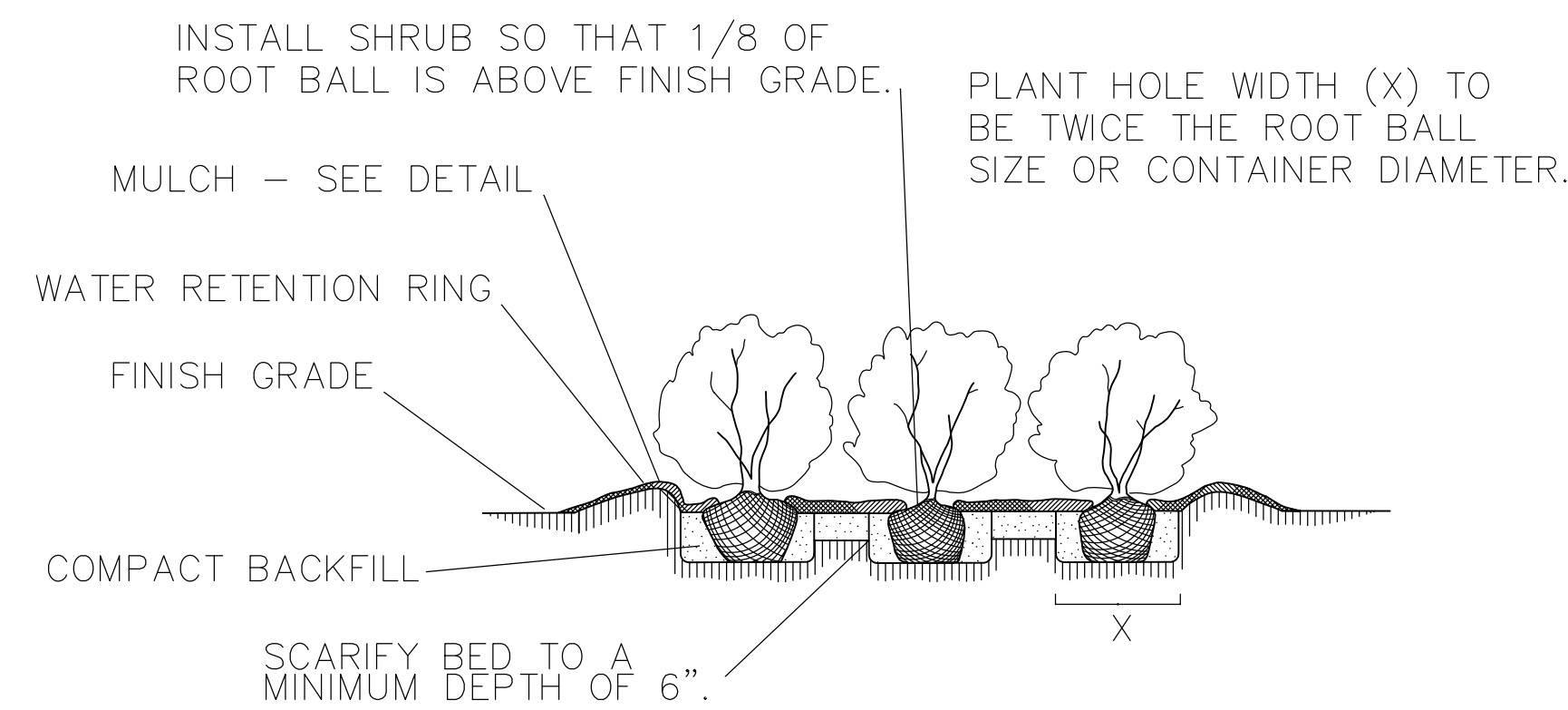

SHRUB BED PLANTING DETAIL

NOTES:

- SCHEDULE FOR PLANT HOLE SIZE: PLANT HOLE WIDTH (X) TO BE TWICE THE ROOT BALL SIZE OR CONTAINER DIAMETER.
- SEE STANDARD SPECIFICATIONS FOR PLANT BED FUMIGATION AND HERBICIDAL TREATMENT.
- APPLY FERTILIZER AT PLANTING TIME IN THE FORM OF A SLOW RELEASE PELLET OR TABLET. APPLY AT RATE RECOMMENDED BY MANUFACTURER. BOTH RATE AND FORMULATION MUST BE APPROVED BY FIELD ENGINEER PRIOR TO APPLICATION.
- REMOVE WIRE BASKET AND FOLD BURLAP BACK FROM TOP OF ROOT BALL BEFORE BACKFILLING IS COMPLETE.
- ALL PRUNING TO FOLLOW STANDARD ARBORICULTURAL PRACTICES AS SPECIFIED BY INTERNATIONAL SOCIETY OF ARBORICULTURE.

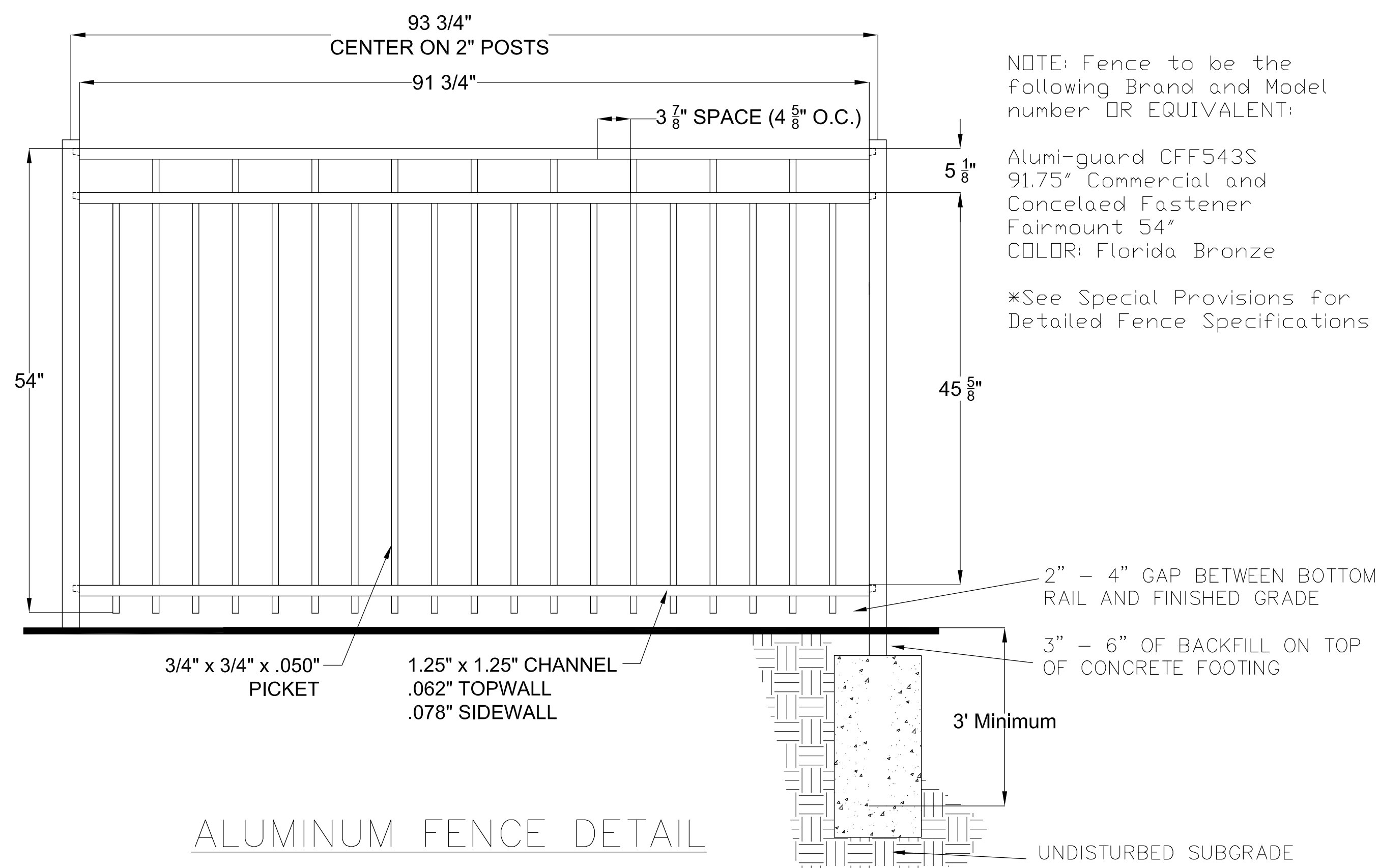

ALUMINUM FENCE DETAIL

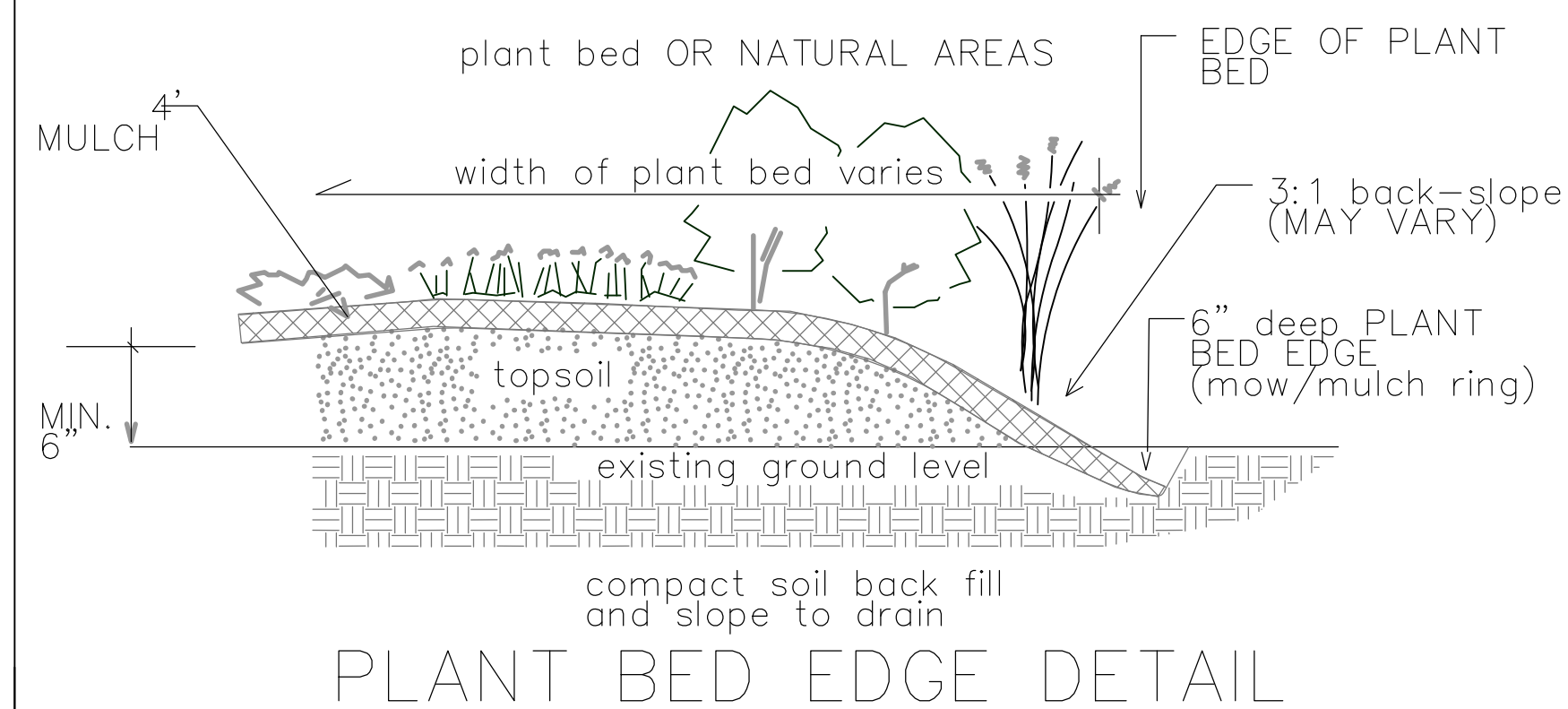

PLANT BED EDGE DETAIL

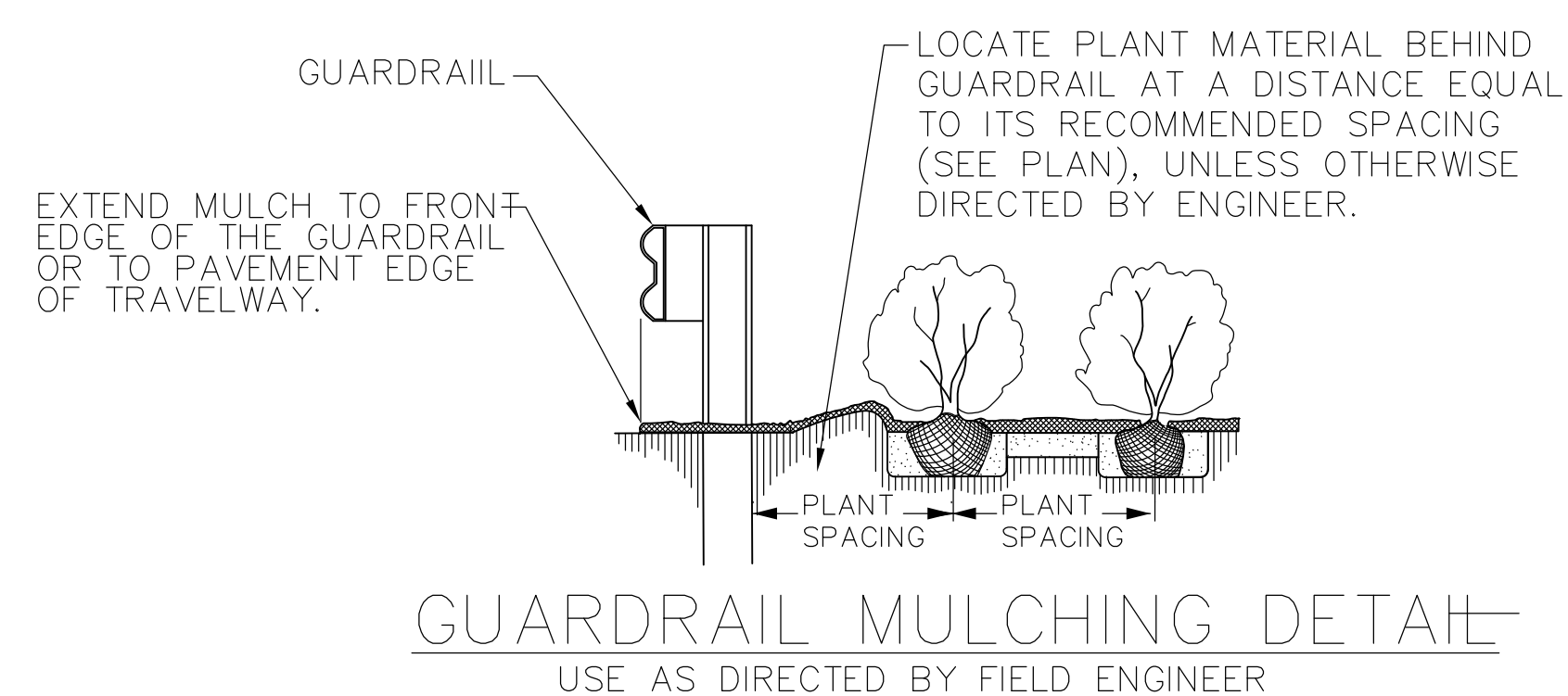

GUARDRAIL MULCHING DETAIL  
USE AS DIRECTED BY FIELD ENGINEER

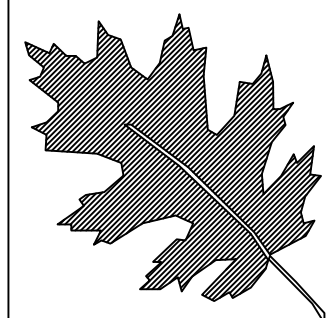

NCDOT – ROADSIDE ENVIRONMENTAL UNIT  
LANDSCAPE DESIGN & DEVELOPMENT  
1557 MAIL SERVICE CENTER, RALEIGH, NC 27699-1557  
PH: 919-707-2920 FAX: 919-715-2554  
[http://www.ncdot.org/doh/operations/dp\\_chief\\_eng/roadside/](http://www.ncdot.org/doh/operations/dp_chief_eng/roadside/)

Landscape Renovation/Enhancement  
US 74A, Isothermal College Entrance  
Spindale, NC  
project #: 3713.3.32

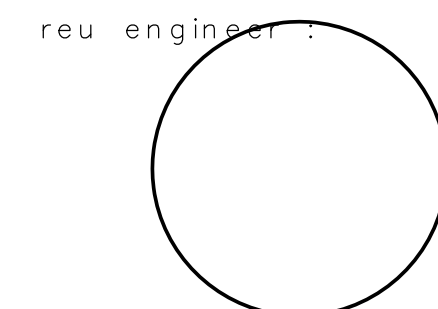

sheet description:  
Planting and Fence  
Details

prel design date: March 26, 2015

checked by & date : Connie Morgan  
April 8, 2015

final design date : April 13, 2015

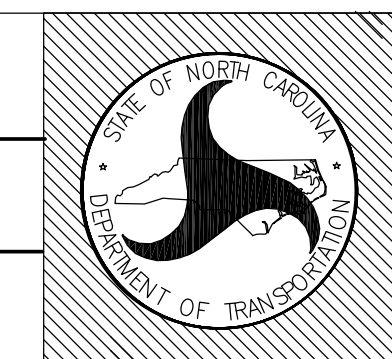

sheet no :

L-2

total sheet no : 3





PLANT MATERIALS							
Qty	Unit	Key	Botanical Name	Common Name	Furnish	ASNS	Spacing
<b>Shrubs</b>							
115	ea	CH	Cephalotaxus harringtonia 'Prostrata'	Creeping Plum Yew	15-18", #3 Container	3.2.1	3' O.C.
<b>Groundcover</b>							
113	ea	HP	Heuchera 'Peppermint Spice'	Peppermint Spice Coral Bells	#1 Container, fully rooted	12.3	12" O.C.
4615	ea	SH	Sporobolus heterolepis 'Tara'	Dwarf Prairie Dropseed	4" Container, fully rooted	12.4	12" O.C.
3500	ea	NA	Narcissus 'Carlton'	Daffodil	RN III	10.19	4-5 inches O.C.

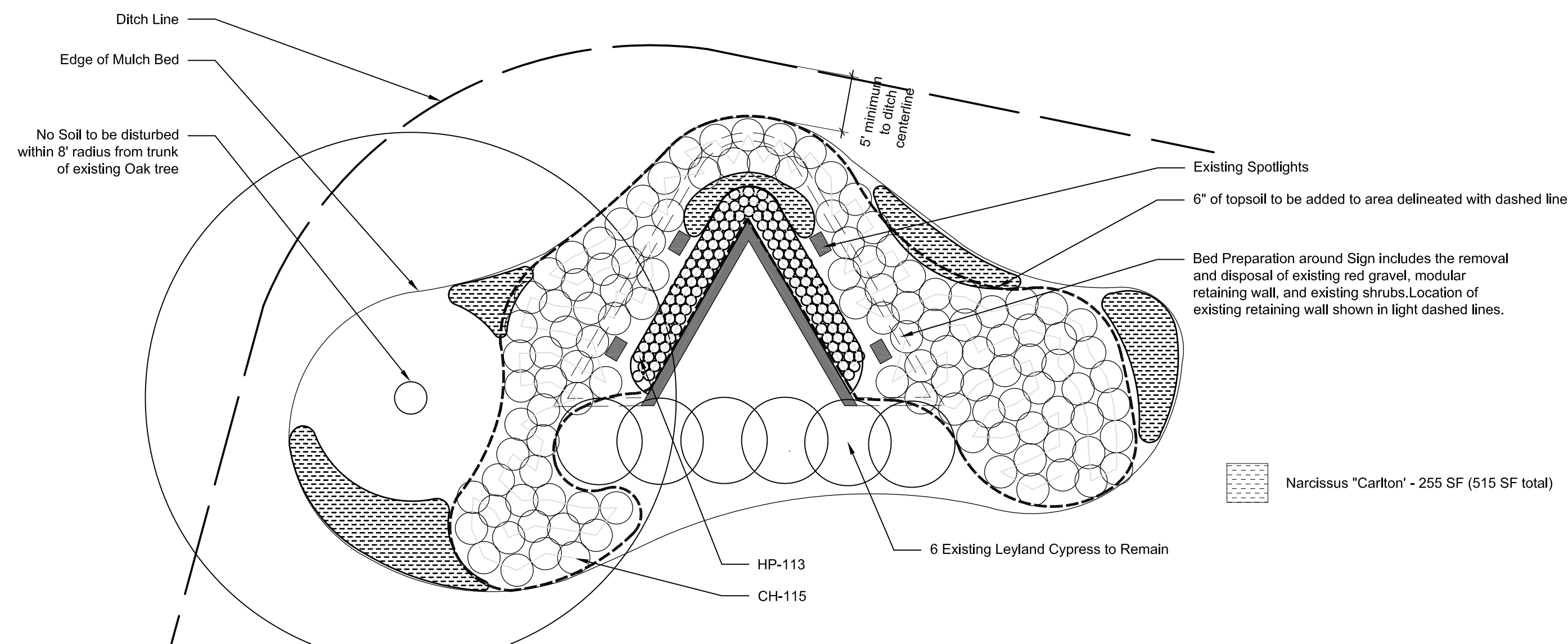

NCDOT – ROADSIDE ENVIRONMENTAL UNIT  
**LANDSCAPE DESIGN & DEVELOPMENT**  
 1557 MAIL SERVICE CENTER, RALEIGH, NC 27699-1557  
 PH: 919-707-2920 FAX: 919-715-2554  
[http://www.ncdot.org/doh/operations/dp\\_chief\\_eng/roadside/](http://www.ncdot.org/doh/operations/dp_chief_eng/roadside/)

Landscape Renovation/Enhancement reu engineer  
 US 74A, Isothermal College Entrance  
 Spindale, NC  
 project #: 3713.3.32

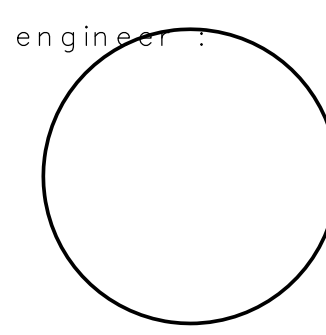

sheet description: **Planting Plan**

prel design date: March 26th, 2015  
 checked by & date : Connie Morgan  
 April 8, 2015  
 final design date : April 13, 2015

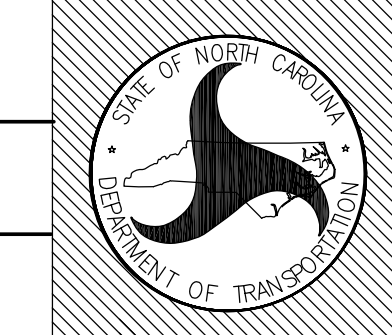

sheet no : **L-3**  
 total sheet no : **3**